

Montageanleitung

Gewindebohrung
mit Flachdichtung

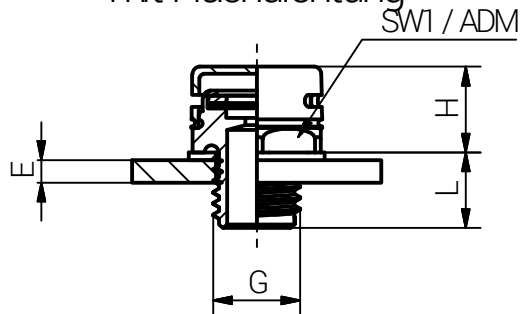

E= Min. 3,0 mm
Flachdichtung

Durchgangsbohrung
mit Flachdichtung

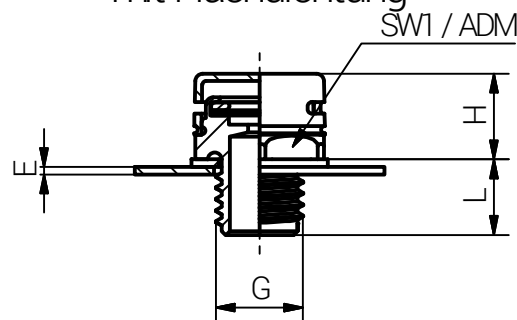

E= Max. 1,0 mm für 6,0 mm Gewindelänge
E= Max. 5,0 mm für 10,0 mm Gewindelänge

Gewindebohrung
mit O-Ring

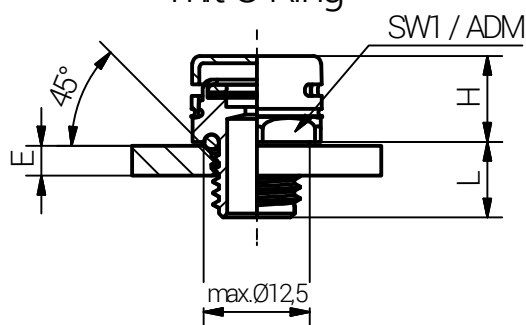

E= Min. 3,0 mm
O-Ring

Durchgangsbohrung
mit O-Ring

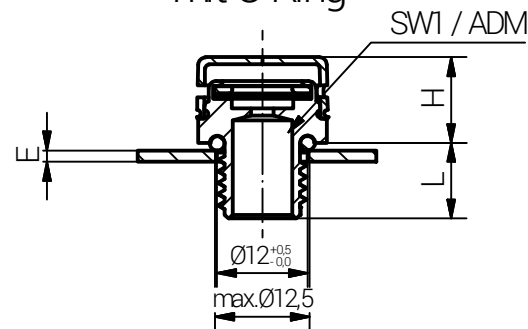

E= Max. 1,5 mm für 6,0 mm Gewindelänge
E= Max. 5,0 mm für 10,0 mm Gewindelänge

Schritt	Montageschritt (Die Installation sollte nur von einem qualifizierten Elektriker durchgeführt werden, der in der Installation von Kabelverschraubungen geschult ist.)	Artikel	Membrantyp	Gewinde G	SW1 (mm)	L (mm)	H max. (mm)	Anzugsdrehmoment (Nm) ADM Toleranz ±0,1
1	Druckausgleichselement mit dem Anschlussgewinde am Gegenstück (z.B. Elektronikgehäuse) montieren und soweit anziehen, dass der O-Ring seine Funktion erfüllt. Zu festes Anziehen kann zu Beschädigungen führen. Zu festes Anziehen sollte seitlich montiert werden.	90000512	S	M12x1,5	17	10,0	11,0	0,5
		90000514	S	M12x1,5	17	6,0	11,0	0,5
		90000407	S	PG 7	17	10,5	11,0	0,5
		90001512	S	M12x1,5	17	10,0	11,0	0,5
		900015140	S	M12x1,5	17	6,0	11,0	0,5
		90001407	S	PG 7	17	10,5	11,0	0,5

	RST Pabe-System-Technik und Vertriebs-GmbH Otto-Lilienthal-Strasse 19 49134 Wallenhorst ☎ +49 5407 8766-0 ☎ +49 5407 8766-99 ✉ info@rst.eu	Unless otherwise specified on the drawing: Metric Thread = EN 60423 PG Thread = DIN 40430 NPT Thread = ANSI B1.20.1 Tolerance: DIN ISO 2768-m All dimensions in mm.	Abusively use, in particular reproduction and dissemination to third parties is not permitted. You can be punished by civil law. Technical changes are reserved.
---	---	--	--

				Date	Name	<h2>Druckausgleichselement M/PG</h2>												
				Draw.	10.07.2018				SL									
				Appr.	10.07.2018				KH									
				Norm														
				Scale:					1:1									
				Material:	Edelstahl		Drawing-Nr.:	9000xxxx_SZMPG_TD_German	1	of 1								
B	Text	09.11.2020	SL					A4										
A	Toleranz	18.11.2019	SL					V15										
Status	Modification	Date	Name	Z:\Inventor\Montageanleitung\Druckausgleichselement\DAE_Edelstahl_M_PG_9000xxxx\DAE-02-1-BG-0001-9000xxxx_SZMPG_TD_German.idw														

Bitte beachten Sie, dass es sich bei der o.a. Darstellung nur um ein Maßbild handelt.

Mounting Instruction

Threaded Enclosure
Flat Washer Application

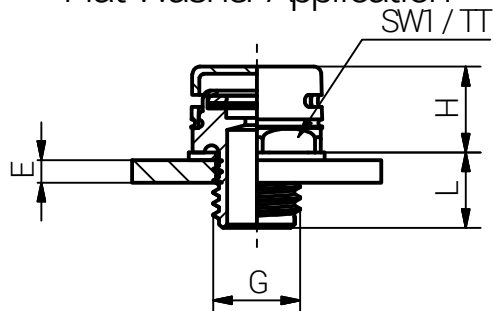

E= Min. 3,0 mm
Flat Washer

Non Threaded Enclosure
Flat Washer Application

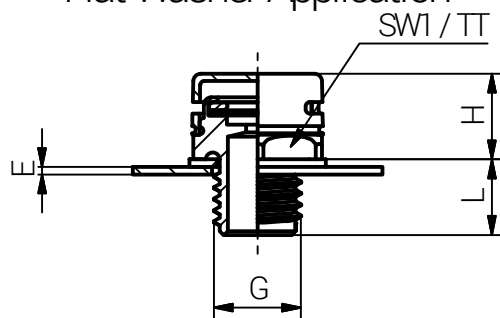

E= Max. 1,0 mm für 6,0 mm plug thread length
E= Max. 5,0 mm für 10,0 mm plug thread length

Threaded Enclosure
O-Ring Application

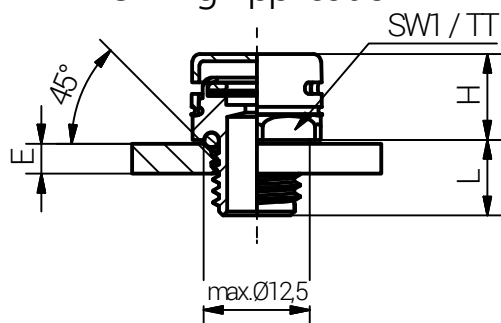

E= Min. 3,0 mm
O-Ring

Non Threaded Enclosure
O-Ring Application

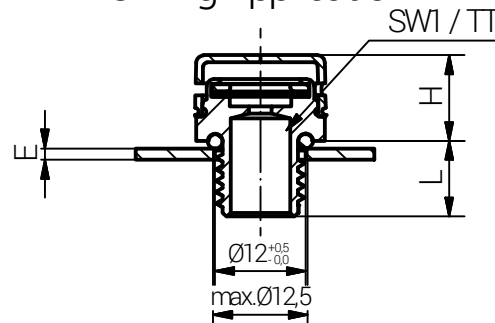

E= Max. 1,5 mm für 6,0 mm plug thread length
E= Max. 5,0 mm für 10,0 mm plug thread length

Step	Assembly Steps (The installation should only be done by a qualified electrician who are trained in the installation of cable glands.)	Article	Type of membrane	Thread G	SW1 (mm)	L (mm)	H max. (mm)	Tightening Torque (Nm) TT Tolerances ±0,1
1	Mount the pressure balance element with the connection thread on the counterpart (e.g. electronic enclosure) and tighten until the O-Ring fulfills its function. Over tightening may cause damage.	90000512	S	M12x1,5	17	10,0	11,0	0,5
		90000514	S	M12x1,5	17	6,0	11,0	0,5
		90000407	S	PG 7	17	10,5	11,0	0,5
		90001512	S	M12x1,5	17	10,0	11,0	0,5
		900015140	S	M12x1,5	17	6,0	11,0	0,5
		90001407	S	PG 7	17	10,5	11,0	0,5

The pressure equalization element should be mounted laterally.

 <small>connected by competence</small>	RST Pabe-System-Technik und Vertriebs-GmbH Otto-Lilienthal-Strasse 19 49134 Wallenhorst ☎ +49 5407 8766-0 ☎ +49 5407 8766-99 ✉ info@rst.eu	Unless otherwise specified on the drawing: Metric Thread = EN 60423 PG Thread = DIN 40430 NPT Thread = ANSI B1.20.1 Tolerance: DIN ISO 2768-m All dimensions in mm.	Abusively use, in particular reproduction and dissemination to third parties is not permitted. You can be punished by civil law. Technical changes are reserved.
---	---	--	--

				Date	Name	<h2 style="margin: 0;">Pressure Balance Elements M/PG</h2>			
				Draw.	17.07.2018				SL
				Appr.	17.07.2018				KH
				Norm					
				Scale:					1:1
				Material:		Stainless Steel	Drawing-Nr.:	<div style="font-size: 2em; font-weight: bold;">1</div> of 1	
B	Text	09.11.2020	SL			9000xxxx_SZMPG_TD_English	A4		
A	Tolerances	18.11.2019	SL				V15		
Status	Modification	Date	Name	Z:\inventor\Montageanleitung\Druckausgleichselemente\DAE_Edelstahl_M_PG_9000xxxx\DAE-02-1-BG-0001-9000xxxx_SZMPG_TD_English.idw					

Please note that the above representation is just a dimension illustration.